

Technical data sheet

Title	Safety washers for shafts
Standard	DIN6799

1.- Functions of washers.

The main functions of washers are:

- 1.- To protect contact surfaces against scratches or wear that may be caused by screws or nuts by rubbing.
- 2.- To distribute the tightening force evenly to obtain local pressures that are close to the average pressure.
- 3.- To move the tightening force to different areas of the head of the screw or nut. Oversized or torn holes.
- 4.- To reduce the risks of loosening due to increase in the friction coefficient on the screw or nut (serrated or ribbed washers)
- 5.- To secure a possible loss of tightening torque due to deformation of the parts (elastic washers)
- 6.- To compensate for the lack of parallelism of the parts or uneven surfaces.
- 7.- Watertightness between the head or screw or nut and the part to be tightened (polyamide coated washer).
- 8.- Fastening of cables to the electrical connections.

2- Application and classes of washers

DIN6799 safety washers are made from spring steel and have a hardness of 46HRC to 54HRC, with Black finish.

3.- Dimensions of washers

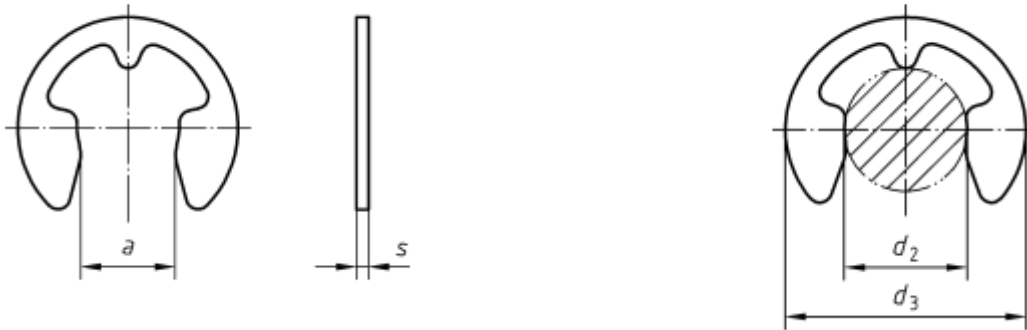

MEASUREMENT	a	s	d2	d3
1.4	0.58	0.2	0.8	2.25
2	1.01	0.3	1.2	3.25
2.5	1.28	0.4	1.5	4.25
3	1.61	0.5	1.9	4.8
4	1.94	0.6	2.3	6.3
5	2.70	0.6	3.2	7.3
7	3.34	0.7	4	9.3
8	4.11	0.7	5	11.3
9	5.26	0.7	6	12.3
11	5.84	0.9	7	14.3
12	6.52	1	8	16.3
14	7.63	1.1	9	18.8
15	8.32	1.2	10	20.4
18	10.45	1.3	12	23.4
24	12.61	1.5	15	29.4
31	15.92	1.75	19	37.6
38	21.88	2	24	44.6
42	25.8	2.5	30	52.6