

# Technical data sheet

<b>Title</b>	Snap hook.
--------------	------------

## 1.- Purpose and field of application.

Screw lock snap hook made of galvanised steel.

Snap hooks allow direct connections to be made between different elements.

## 2. Dimensions.

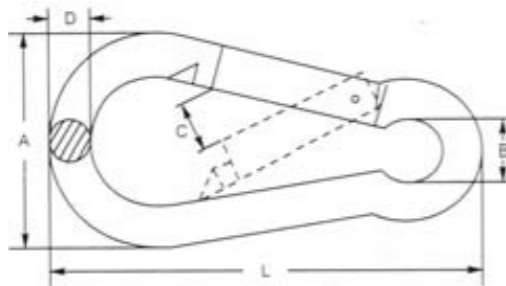

SIZE	A	B	C	D	L	SWL
	nom	Nom	Nom	Nom	Nom	kg
4X40	20	6	6	4	40	45
5X50	25	6	7	5	50	75
6X60	30	9	7	6	60	120
7X70	35	10	10	7	70	150
8X80	40	11	11	8	80	180
9X90	45	13	11	9	90	230
10X100	50	16	12	10	100	300
11X120	57	18	19	11	120	320
12X140	67	20	20	12	140	365
13X160	74	22	29	13	160	590
14X180	86	22	42	14	180	725
15X200	90	26	42	15	200	820

## 3- Installation and recommendations

Inspection of the clips is recommended before each use to ensure that there is no damage to the body, latch and rivet. And that there are no defects in the material and that this is not bent or cracked and is rust-free.